

LH-801ZB Gas Leakage Sensor Manual

Please read this manual carefully before use, iHORN reserves the final interpretation right of this manual

Packing List

Make sure the device & accessories complete after unpack as below.

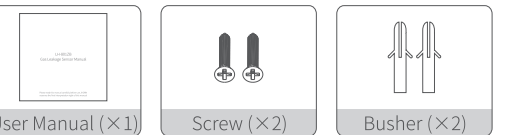
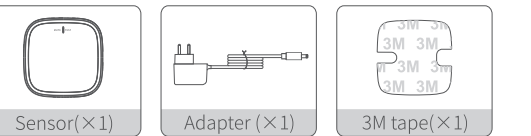

The AC adapter is used as the disconnect device, the disconnect device shall remain readily operable.

Appearance & Feature

Appearance

LED Indicator/Button

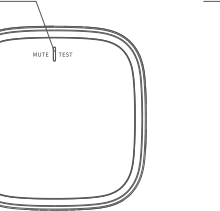

Adapter Socket

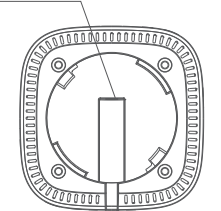

Diagram of back after removal of bracket

LED & Sound

Red LED flickering	Buzzer "Di Di---"	Gas leakage alarm
Red, green and yellow LED flash alternately	Doesn't sound	Sensors warming up
Green LED on	Doesn't sound	Normal working status
Yellow LED on	Buzzer keep sounding	Fault

Feature

With advanced low current gas leakage sensor, built-in temperature compensation module, this gas leakage sensor works steady and simple installation what can detect gas leakage in time and send alarm signal; It can be used at home, hotel and apartment for security monitoring, and it conforms to the standard of GB 15322.2-2003.

Product Usage

Install iHORN Smart Life App

Scan the QR code below to download the " iHORN Smart Life " App.

Or search for " iHORN Smart Life " in App Store or Google Play to download and install, and create a new account.



Add device

1. Connect your phone to your home Wi-Fi.
2. Add gateway to the App according to the gateway user guide.
3. After the gateway is successfully added, open the "iHORN Smart Life "App, click to enter the gateway page, click "Add", select "Gas Leakage Sensor", and follow the prompts for subsequent operations
4. Select counterclockwise to open the product bracket, plug in the adapter DC plug and turn on the power, the green LED flashes quickly, the device automatically enters into the enrolling mode.
5. Keep pressing the button for 5 seconds, you can also enter into the sub-device enrolling mode, the green LED will flash quickly.
6. Click "Confirm indicator rapidly blink" in the App, the gateway voice prompts to enter into the sub-device enrolling mode.

If the indicator is blinking fast, please skip the reset steps

- ① Turn on the device
- ② Hold RESET button (switch) for 5s. (please refer to the manual)
- ③ Confirm that the indicator is blinking fast

Attention: please complete pairing process within 3 minutes after device reset.



Confirm indicator rapidly blink

Installation instruction

1. This product is suitable for natural gas detection with ceiling mounted. The installation position is selected from 1.5m-3m directly above the gas source.

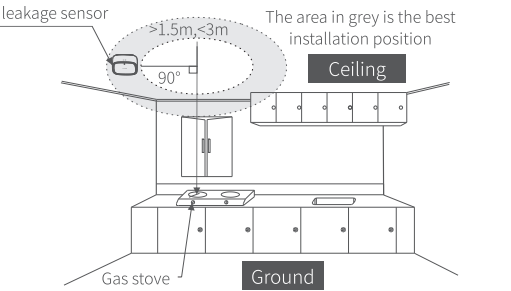

2. Fix the bracket to the wall with screws or 3M tape, then rotate detector into the bracket in clockwise direction. If use 3M tape, please make sure the wall surface firm, smooth and clean, in case of dropping.

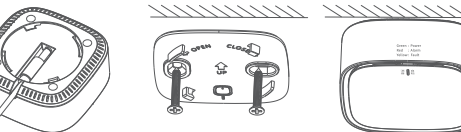

Installation notice

1. Please refer to the installation diagram when installing. If the site is unconditional, the installation person should be considered the relevant factors of the installation environment to find the best installation location and ensure that the product is in effective monitoring.

2. Notice: The gas released from house decoration will damage the sensor, and it's unrecoverable and can cause false alarm of failure of the product, When decorating, it is suggested to use the formal environmental protection materials: In order to achieve dust proof effect, please do not remove the product blister cover before using this product; Open the door and window to maintain indoor ventilation, and if possible, the sensor can be temporarily removed.

Installation environment

1. It should also be noted that the installation location can not be close to the gas stove, to avoid the heat or the smoke from stove which will cause false alarm and affects the sensitivity of the sensor.
2. Avoid long-term effects of high temperature water vapor and soot on the product; if cannot avoid, should add fan, ventilator and other equipments.

Hereby, China Security & Fire IoT Sensing Co., Ltd. declares that the radio equipment type is in compliance with Directive 2014/53/EU. The full text of the EU declaration of conformity is available at the following internet address: <http://www.ihorn-tech.com/Service/Download.html>

Special instructions:
(1)The product comply with RF specifications and technical standards, which can be used in a small communication range;
(2)The product comply with the DOC statement.

Manufacturer: China Security & Fire IoT Sensing Co., Ltd.
Address: The 4th Building, 1st floor of the 5th Building, New and High Technology Industrial Park, Guangming, Wandaiheng, Baoan, Shenzhen, China

3. Avoid a high humidity or water vapor and drip installation place.
4. Avoid installation in high or low temperature environment (not higher than 55 °C or lower than -10 °C).
5. Avoid the sensor in a environment with the following gases; silicone vapor, formaldehyde, toluene, acetic acid, and hydrogen sulfide, They are mainly produced from home decoration, decorative materials, such as adhesives, wall paint, hair gel, silicone rubber...etc. These gases can cause damage to the sensor, and can not be restored, leading to false alarms or it failed to use. In addition, high concentration of alcohol vapor can lead to a false alarm and a drifting of sensitivity which could not be restored in a long time.

Attention

1. This product must be properly powered, or the sensor will not work.
2. Please power on and take off the plastic cover after 24 hours when use.
3. The product must be periodically maintained according to manual.
4. The sensor is tested at least once every six months. Please repair or replacde asap if fault happen.
5. To ensure effective monitoring of gas leakage, users are advised to replace new sensor at least every 3 years.
6. This product can not be used with high concentration (>100% LEL) gas for testing, or it may reduce sensor's sensitivity and fail to use.
7. This product can reduce the accidents possibility, but the accidents can not be ensured to preven it by 100%. To ensure your security, you should also be vigilant to enhance your safety awareness in daily life after correct use our products.

Daily Maintenance

After a long time use, there will be some oil adhesion in the gas convection holes, and that will affect the sensitivity of the sensor. It is recommended that users use brush to clean the holes with cleanser every therr months (depends on pollution). Do not let the cleanser info the body. After cleaning finished,please test the product again.

Please read this chapter carefully before using this product and follow these instructions and warnings. The company and the manufacturer are not responsible for the consequences of incorrect use or failure to follow the instructions in this manual.

Function

1. Turn on the power of the sensor, the yellow light flashes once, and the buzzer emits a "di" sound, the circuit enters the preheating state, and then the red, green and yellow

- lights flash alternately until the green light is constantly on, indicating that the sensor is in normal working state.
2. In the normal working state, press the button for a short time to perform a self-test of the sensor. The buzzer emits a "di" sound, and the red, green, and yellow lights flash in sequence, and then the green light is always on.
3. If the combustible gas leakage has detected, the LED indicator will in red and flashing,while the buzzer sound DI DI...,and it will send the alarm message, It will restore if there is no more gas detected.
4. The yellow light is always on and the buzzer is beeping for a long time, indicating that the sensor is malfunctioning.
5. When fault detected, please cut off the power and connect the power again,then product start self-inspection.If the buzzer is still ringing,cut off the power and repair or replace it with a new one asap.

Operating instructions

After the gas sensor is installed, power on until the green light is on. Press the self-test mute button to enter the test mode, and the test mode will automatically exit after 1 minute.
Use the lighter test, the test method is as follows:
Find a transparent plastic bag, fill it with an appropriate amount of air, and then use a lighter to inject gas into the bag without firing for about 5 seconds and then stop the injection. Shake the air well, and then put the sensor in a plastic bag. The sensor should report the alarm immediately. Remove the sensor immediately after the alarm. If sensor can't alarm, you can refill the gas. Due to limit of the sensor, please do not release too much gas or test it frequently, which may damage the sensor and reduce the reliability.

Alert handling

When the gas over the threshold, this product will alarm for this dangerous situation. At this moment we suggest you to:
1. Immediately close the pipe valve;
2. Immediately open the window or door;
3. Extinguishing all fire sources, such as fireworks, firelighter, matches etc.
4. Do not turn on any electrical appliances;
5. Check out the reason of gas leakage, and promptly notify the relevant departments or professionals to deal with.

Trouble shooting

Troubles	Reasons	Solution
Always warm up after power on(Red, green and yellow lights flash alternately)	1. Long time no electricity 2. Gas detected	1.Power on to age this product for 24 hours 2.Make sure no gas detected, and power on again
LED in yellow, buzzer ringing	Sensor fault	Contact the local distributor

Technical parameter

Wireless protocol	ZigBee 3.0
Transmit power	≤10dBm
Working voltage	DC12V(adapter)
Standby current	≤100mA(DC12V)
Alarm current	≤150mA(DC12V)
Working temperature	-10°C~+55°C
Working humidity	≤95%RH, No condensation
Alarm concentration	8%LEL, tolerance ±3%LEL
Concentration tolerance	±5%LEL
Alarm sound	≥70dB(front 1m)
Alarm method	Sound and light alarm, wireless networking alarm
Detection gas type	Natural gas(CH ₄)
Dimension	66×66×29mm

Restore Factory Settings
When the device is powered on, press and hold the network access button for 5 seconds, the green LED starts to flash quickly, and the gas leakage sensor automatically enters the network distribution state after restoring factory settings.

Guarantee
Dear customer :
Thank you for choosing the equipments. Please read the instructions carefully before installation:
1. Our guarantee time is one year from the date you bought. Under the condition of correct operation following the manual, if fault happens during the warranty period, we'll repair for free. If fault happens in seven days, we can change for you for free.
2. The following conditions are not covered by the warranty.We will charge the repair if there are below conditions during warranty period:
• The false caused by wrong operation or using environment.
• The other faults that are not caused by our design, technology, quality and manufacturing.
• Fault caused by working with the third party products, software and so on.
• Improper installation, misuse, unauthorized repair, modification, accident, force majeure event or other external cause of failure or defect.
• Product has exceeded warranty period.
The final interpretation right belongs to China Security & Fire IoT Sensing Co., Ltd.