

HO-011ZB Scenario Button Manual

Please read this manual carefully before use, iHORN reserves the final interpretation right of this manual

Packing List

Make sure the device & accessories complete after unpack as below.

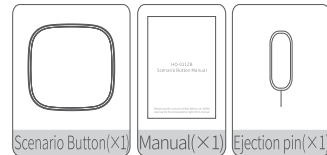

Batteries (battery pack or batteries installed) shall not be exposed to excessive heat such as sunshine, fire or the like.

Appearance & Feature

Appearance

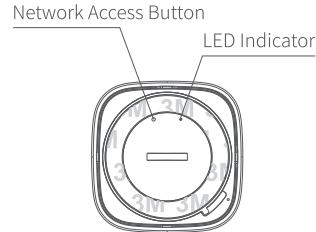
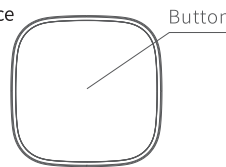

Feature

Performs user-defined functions in the App when the user presses a button.

Product Usage

Install iHORN Smart Life App

Scan the QR code below to download the "iHORN Smart Life" App.



Or search for "iHORN Smart Life" in App Store or Google Play to download and install.

Add Device

1. Connect your mobile to your home Wi-Fi.
2. Open the "iHORN Smart Life" App.
3. Add the gateway to the App according to the gateway user guide.
4. After the gateway is successfully added, go to the gateway interface and select "Add>Scenario Button" and follow the instructions.

5. Use a tool (such as a coin) to open the bottom cover of the product by turning it counterclockwise in the direction shown.

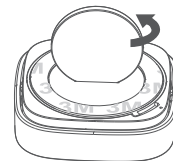

6. Remove the battery insulation strip, the blue LED flashes quickly, and the scenario button automatically connects to the gateway within 30 seconds.

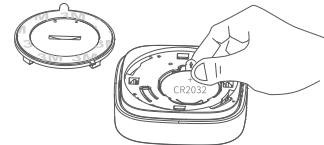

7. If adding sub devices fails, please move the scenario button closer to the gateway and use a pin to press the network access button for 5 seconds, the blue LED will flash and enter into the enrolling mode.

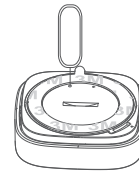

Reset the device first.

Power on the device and confirm that indicator light rapidly blinks



Resetting Devices >

Confirm indicator rapidly blink

8. Wait for the scenario button to be added successfully.

Hereby, China Security & Fire IoT Sensing Co., Ltd. declares that the radio equipment type is in compliance with Directive 2014/53 /EU. The full text of the EU declaration of conformity is available at the following internet address: <http://www.ihorntech.com/Service/Download.html>

Special instructions:

- (1)The product comply with RF specifications and technical standards, which can be used in a small communication range;
- (2)The product comply with the DOC statement.

Manufacturer:
China Security & Fire IoT Sensing Co., Ltd.
Address: The 4th Building, 1st floor of the 5th Building, New and High Technology Industrial Park, Guangming, Wandaiheng, Baoan, Shenzhen, China

Installation Instruction

Tear off the centrifugal paper from 3M adhesive and fix the product to the desired position through the 3M adhesive.

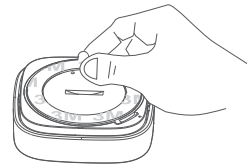

Function Instruction

1. This product needs to be used with gateway. When using the product for the first time or replacing the gateway, it needs to be enrolled with the gateway.
2. There are three trigger modes for scenario button: single-click, double-click, and long-press (more than 3 seconds). You can realize the smart home linkage scenario through the simple setting of the App. For example: single click to turn on light, double-click to trigger security mode, and long press to turn on home appliances.

3. This product has a low voltage reminder function. When the product battery voltage is low, the scenario button will send a low voltage reminder to the gateway.

Technical Parameter

Wireless protocol	ZigBee 3.0
Transmit frequency	2.4000~2.4835GHz
Transmit power	<10dBm
Battery type	CR2032
Quiescent current	<5μA
Working temperature	-10°C~+55°C
Working humidity	≤95%RH
Dimension	44.5×44.5×13.0mm

Restore Factory Setting

When the device is powered on, press and hold the network access button for 5 seconds, the blue LED starts to flash quickly, and the scenario button automatically enters the enrolling state after restoring factory settings.

Guarantee

Dear users, thank you for choosing our products. Please read the following content carefully before installing and using this product:

1. The warranty period is one year from the purchase date, and we will provide free repair for any failure caused by the quality of the product itself under normal use. If you have quality problems within 7 days from the purchase date, you can enjoy free replacement.
2. The following conditions are not covered by the warranty:
 - Failure or defect caused by improper use environment or conditions;
 - Failure or damage caused by other issues than the design, technology, production, product quality;

- Malfunctions or defects caused by the use of third-party products, software or components;
 - Malfunction or defect caused by improper installation, incorrect use, unauthorized repair, modification, accident, force majeure or other external reasons;
 - The product has exceeded the warranty period.
- The final interpretation right belongs to China Security & Fire IoT Sensing Co., Ltd.