

MC-800DMT PIR Intrusion Detector Instruction Manual

1 Introduction

The MC-800DMT is a passive infrared intrusion detector that detects accidental or malicious intrusions and meets general protection needs. It is designed as a small-sized white round streamline shape, and the ideal installation height is 2.3m (7'66") from the ground. The lower view protection zone can avoid the protection dead angle, and the sensitivity can be set to suit the installation environment. This product has a built-in protective switch. Prevent unauthorized removal.

This product can be widely used in homes, shops, banks, offices, warehouses, garages and other places.

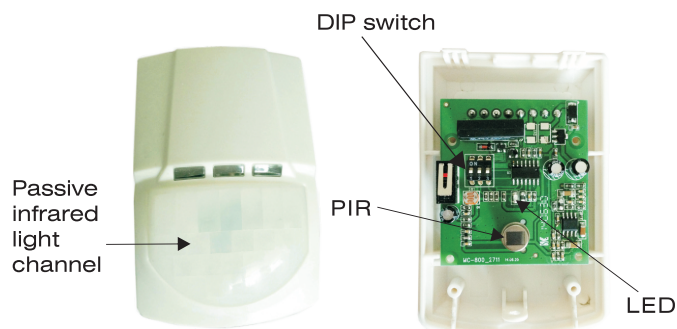

Fig.1 Appearance

Fig.2 Internal Structure

2. Specifications

Model: MC-800DMT

Detection distance: 12m (25°C)

Input voltage: 12V DC

Current consumption: ≤20mA@12V DC
Infrared part (as shown on the right)

Alarm and tamper

Alarm output: Solid relay, N.C.

less 100mA/30V, --10Ω internal impedance

Tamper switch: NC, 50mA/30VDC

less 100mA/30V, --10Ω internal impedance

Alarm indication: LED is on when alarming

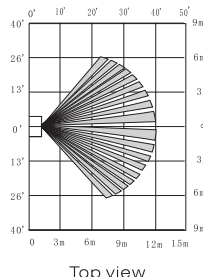

Top view

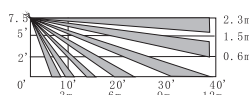

Side view

Installation: wall installation, installation height is 2.0~2.4 meters from the ground.

Working environment

Working temperature: -10 °C ~+50 °C (14 °F-122 °F)

Storage: -20 °C -60 °C (-4 °F-140 °F)

Anti-white light(indoor): > 9000LUX

Anti-emi: 30V /m, 10MHz-1000MHz

Size :(L * W * H) 92 * 61 * 44 mm

3. Installation

3.1 Installation notes

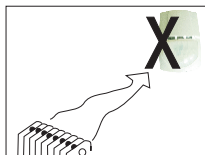

Don not face cool or heat source directly

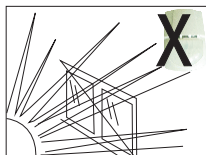

Don not face the sunshine directly

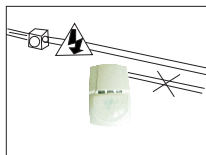

Wire connection or detector should be away from High-voltage cable

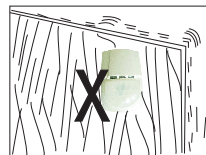

Don not install on unstable object



Don not install facing the metal wall

3.2 Pet-immunity manual

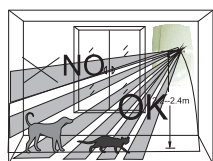

The top part of detection area is non pet-immunity area

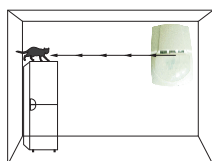

Never face the detector to the place that pets can climb up directly

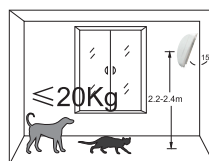

Pet immunity: ≤20Kg pets

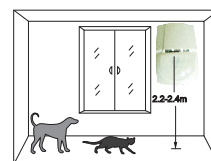

Pet immunity installation height: 2.2-2.4m

3.3 Installation

1) Disassemble procedure :

Press the handles on both sides of the bracket by hand to forcefully separate the product from the bracket

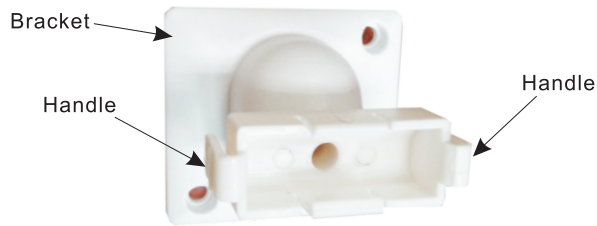

3.4 DIP Switch Function Description

a. DIP 1 is N.O. and N.C. Select:
ON is N.O., OFF is N.C., and default is OFF.

b. DIP 2 for sensitivity selection:
ON is low sensitivity,
OFF is high sensitivity, default is OFF.

c. DIP 3 is the indicator light switch: ON when it is ON, OFF when it is OFF, and ON by default.

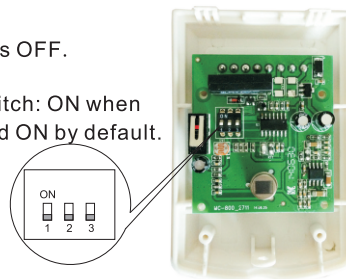

2) Installation basis: Mount the bracket at a height of 2.0-2.4 meters from the ground

Mounting screw preset hole

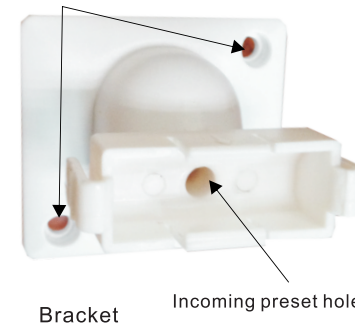

A. Mark the drilling point and drill holes in the wall

B. Introduce the wires from the bottom of the bracket into the terminal block

C. Fix the bracket to the wall with two screws

D. Connect the wire to the terminal block and install the wiring block in the bracket in the correct direction

E. Mount the product on the bracket

Bracket Incoming preset hole

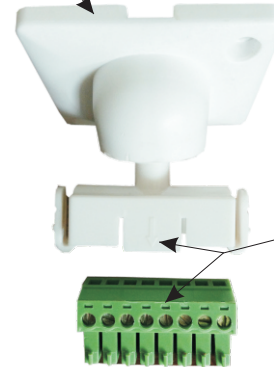

Note: When installing the terminal block, the screw hole surface of the terminal is consistent with the arrow face marked on the bracket

3.5 Terminal connection

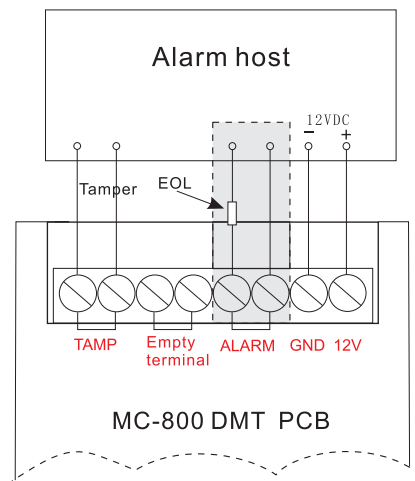

3.6 Walk-test on the coverage area:

Assemble the front cover(as shown in figure)

- ① Electrify and self-check then start walk-test.
- ② Walk across the end of coverage area, the indicator LED should light red for 2-3 seconds.
- ③ Do walk-test in opposite direction to confirm the boundary of both sides. make sure the detection centre pointing to the centre of protected area.
- ④ Slowly put hands up the detection area where 3-6 meters away from the detector and mark the bottom border of the PIR alarm. Repeat to confirm the top border.
- ⑤ Make sure the detection centre at the proper place. Should properly adjust the detection area if you can not get an ideal detection range.

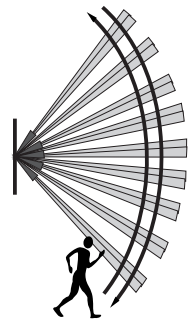

Important: To ensure continued good probe function, it is recommended to walk test the detector every three months.

4. Customer service

Our products are very reliable, but for some special reasons, the working performance will be limited in certain range. We here list some cases as follows:

1. The voltage of control panel is not stable
2. Low-voltage of the detector.

For any help please contact with our company and you could visit our website for more information.

Warning: we are not responsible for the problem caused by incorrect operation by users.