

Fingerprint Door Lock

Content

Specification	1
Structure	2
After Install the Lock on door	3
Fingerprint Setting	3
Introduction	3
Add User	4
Modify User	4
Delete User	4
Password Setting	5
Introduction	5
Add Password	5
Delete Password	5
Phantom Password Technology	5
IC Card	6
Introduction	6
Add IC Card	6
Delete IC Card	6
System setting	6
Time Set	6
Way of Open	6
Language	7
Factory	7
Voice Set	7
Tamper Set	7
Record	7
Access Record	7
Register Information	7
Version Information	7
Network Setting (optional)	8
Connect the Fingerprint Door Lock to Gateway	8
Unlock Alert	8
Low Voltage Alert	8
Temporary Password Notification	9
Anti-burglar Alarm and Notification	9
Force Alarm and Notification	9
Key Essentials of Fingerprint Collection	9
Unlock Guidance	10
Battery Installation Issues	10
Lock Installation Guidance	11
Check Direction of Opening the Door	11
Material list	11
Lock Body Installation	13
Faceplate Installation	15
Maintenance	16

Specification

1. Swedish FPC semiconductor fingerprint module.
2. 5 groups of admin fingerprints, 95 groups of users fingerprints.
3. 304 stainless steel Material, touch screen, OLED display.
4. Stainless steel lock–tongue, super grade C lock cylinder, avoid unlock by tinfoil;
5. Adopt phantom password technology, you can add some numbers before/after you input the real password, which can avoid other people peep your password.
6. Unlock ways: fingerprint, password , IC card, mechanical key.
7. Pull up the handle to back locking and activate the top/bottom lock bolts. Rotate the knob to deadlock.
8. Voice prompt for operation.
9. 4*AA Alkaline batteries, work for 1 ~ 2 years, support low battery alert, support 5V emergency electrical power supply.
10. Types of door: 44–120mm thickness, wooden door, iron gate, various of composite material security doors.

Structure

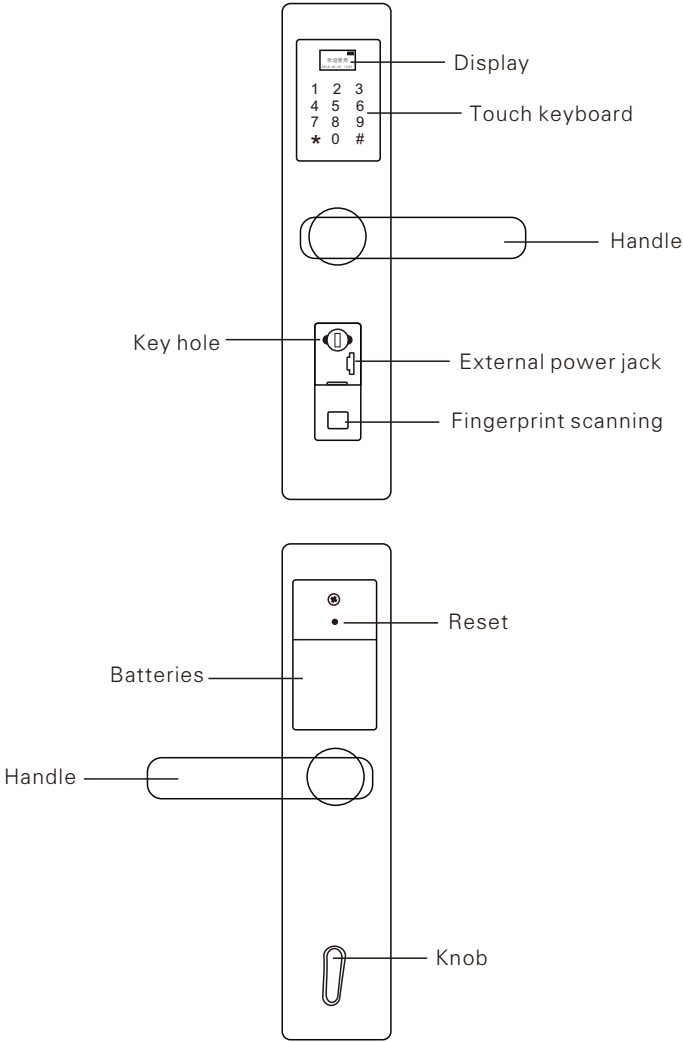

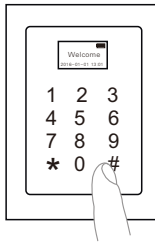

2: up

8: down

#: set or confirm

*: cancel, return or delete

Handle: pull down the handle to open the door, pull up the handle to back locking and activate the top/bottom lock bolts.

Knob: rotate the knob to deadlock.

Reset: long press the reset button about 5s, then the lock will reset to default setting.

Note: when the keyboard under sleep status, please touch the keyboards to wake up the screen, then users can see the LCD display and digitals.

After Install the Lock on door

1. Install the batteries.

2. Input admin fingerprint

Press “#”, scan fingerprint 3 times, then input admin fingerprint succeeds.

Fingerprint Setting

Introduction

A. One lock can support 5 groups of admin fingerprint. The serial numbers are corresponding to 01–05. Each group supports 10 fingerprints.

B. One lock can support 95 groups of user fingerprint. The serial numbers are corresponding to 06–100. Each group supports 10 fingerprints.

Notes:

1. One person use one group, forbid to input two person's fingerprint in the same group. And the fingerprint can not be input repeatedly.

2. One person can totally input 10 fingerprints. When user input his first fingerprint, he can choose “Add User” (see page 4). If user need to input his second fingerprint to his tenth fingerprint, user need to choose “Modify User” (see page 4).

Add User

- ① Press “#” , scan admin fingerprint or enter admin password.
- ② Choose “Fingerprint” , choose “Add user” .
- ③ Choose “Admin” to input admin fingerprint or choose “user” to input user fingerprint.
- ④ Scan the fingerprint 3 times, then input fingerprint succeeds.

Note: user can know his group number by unlock the door; fingerprint group number is assigned automatically, can not change or edit the group number.

Modify User

1.User can add extra fingerprints .

- ① Press “#” , scan admin fingerprint or enter admin password.
- ② Choose “Fingerprint” , choose “Modify user” .
- ③ Choose “Admin/User” , choose “Add fp” .
- ④ Input the group number, press “#” .
- ⑤ Scan the fingerprint 3 times, then input fingerprint succeeds.

2.User can delete fingerprints here.

- ① Press “#” , scan admin fingerprint or enter admin password.
- ② Choose “Fingerprint” , choose “Modify user” .
- ③ Choose “Admin/User” , choose “Del fp” .
- ④ Input the group number, press “#” .
- ⑤ Input the fingerprint number(01–10), press “#” , press “#” again to delete.

Delete User

- ① Press “#” , scan admin fingerprint or enter admin password.
- ② Choose “Fingerprint” , choose “Del user” .
- ③ Choose “Admin/User” .
- ④ Input the group number, press “#” .
- ⑤ Press “#” again to **delete that whole group’ s fingerprints.**

Password Setting

Introduction

A. User can set totally 10 groups of password for each lock. The passwords are formed by 6–12 digitals.

B. The serial number of password is 01–10. 01 group and 02 group are the admin passwords, 03–10 groups are the user passwords.

Add Password

- ① Press “#” , scan admin fingerprint or enter admin password.
- ② Choose “Password” , choose “Add password” .
- ③ Choose “Admin/User” .
- ④ Input password, input password again to confirm, then adding succeeds.

Delete Password

- ① Press “#” , scan admin fingerprint or enter admin password.
- ② Choose “Password” , choose “Del password” .
- ③ Choose “Admin/User” .
- ④ Input the group number, press “#” ; press “#” again to delete.

Phantom Password Technology

User can add some numbers before/after user input the real password, which can avoid other people peep your password.

Anti-peep password inputting:



input fake password

input real password

input fake password

IC Card

Introduction

User can add 10pcs IC card for the lock. If user lost the IC card, please remember to delete it from lock.

Add IC Card

Press “#” , scan admin fingerprint or enter admin password, choose “IC card” , choose “Add IC card” .

Delete IC Card

Press “#” , scan admin fingerprint or enter admin password, choose “IC card” , choose “Del IC card” .

System Setting

Press “#” , scan admin fingerprint or enter admin password, choose “System” , press “#” , then user can set the lock.

Time Set

Immediately input the time, finally press “#” .

Date : year-month-day

Time : hour : minute

Way of Open

1. Fp/Psw/IC : user can unlock the door via fingerprint, password or IC card. This is the default setting.
2. Fp+Psw: user need to scan the fingerprint and enter password to unlock the door.
3. Fp+IC: user need to scan the fingerprint and swipe the IC card to unlock the door.
4. Psw+IC : user need to enter password and swipe the IC card to unlock the door.

Note: user can take page 10 for unlock guidance.

Language

Choose the display language of lock, finally press “#” .

Factory

Reset the lock to default setting.

Note: user can also press reset button to reset the lock, see user manual page 2–3.

After reset the lock, all the fingerprints and passwords will be deleted. It will remind user to input admin fingerprint.

Voice Set

Open/close the voice of lock. After close voice, it will save power for lock.

Tamper Set

Turn on/off tamper switch function of lock.

Note: the default tamper set is off.

Record

Press “#” , scan admin fingerprint or enter admin password, choose “Record” , press “#” , then user can check information.

Access Record

User can check all the unlock records which include unlock time and unlock way. Press “8” to page down, press “2” to page up.

Register Information

User can check the registered admin/user fingerprint number and the rest admin/user fingerprint number here.

Version Information

User can know lock version here.

Network Setting (optional)

The fingerprint can work with gateway to support push alert and alarm alert.

Press “#” , scan admin fingerprint or enter admin password, choose “Network” , press “#” .

Firstly user can turn on “Notification” function, turn on “Alarm” function, set the “Net Password” , set the “Rob Password” and input “Rob fingerprint” .

Note: the gateway is not included in the fingerprint package; if user need, please buy it separately.

Connect the Fingerprint Door Lock to Gateway

1. Download gateway App, make gateway connect with GPRS network and add gateway in App. (check the gateway user manual for guidance)
2. Log in the gateway App, click “Fingerprint lock” , click “Add” , click “Add” again, input the net password of lock, click “confirm” , the gateway will enter coding status.
3. Quickly turn to the lock, choose “Network” , choose “Connection” , choose “on” , press “#” , the lock will start coding with gateway.
4. When the gateway say “learning success” , that means connection successful.

Unlock Alert

User will receive the unlock alerts when the lock is unlocked via fingerprint, password or IC card.

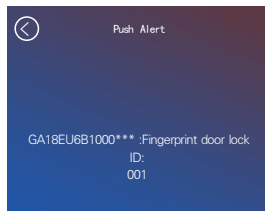

Low Voltage Alert

When the batteries are under low voltage, the battery icon will flash.

There is voice alert when user wake up the lock.

Also user will receive low voltage notification push via gateway App.

Temporary Password Notification

When there is nobody at home or there is an emergency situation, the visitor can contact user and get then temporary password to unlock the door.

1. Visitor press “* * #” on lock.
2. User will receive temporary password on App.
3. Visitor contact user to know the temporary password, and then unlock door with that password.

Anti-burglar Alarm and Notification

If there is anyone try to open the lock shell and trigger the lock's tamper switch, the lock will make alarm sound, it will also trigger gateway alarm. Users who have gateway App will receive intruder alarm notification and hear 3s alarm sound on App, also users will receive alarm call from gateway.

User can release alarm by unlock the door via fingerprint, password, or IC card. Or the lock will stop alarming after 1 minute.

Note:

- 1.user should turn on tamper switch function, see user manual page 7.
- 2.user can check gateway user manual page 8 to know how to set alarm call phone number and how to answer alarm call.

Force Alarm and Notification

When user is forced to unlock the door, he can use the preset “Rob password” or “Rob fingerprint” to unlock the door. Then the lock will trigger gateway alarm. Users who have gateway App will receive intruder alarm notification and hear 3s alarm sound on App, also users will receive alarm call from gateway.

Key Essentials of Fingerprint Collection

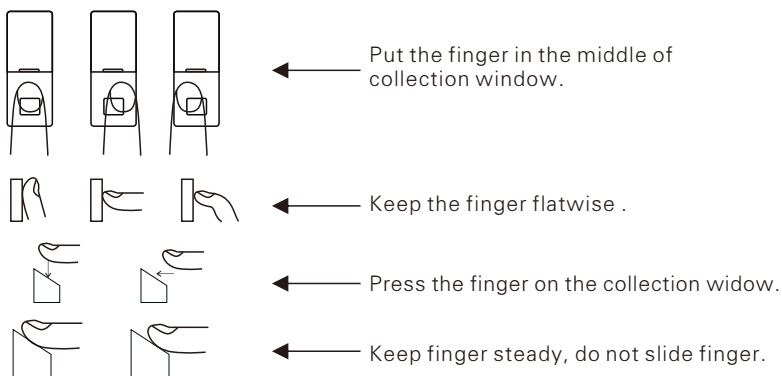

Unlock Guidance

Mechanical key

Insert the key, rotate the key 270 degree, then pull down the handle to open the door.

Password

Touch keyboard to wake up the system, input password, press “#” ; then the door is unlocked, pull down the handle to open the door.

Fingerprint

touch keyboard to wake up the system, scan fingerprint; then the door is unlocked, pull down the handle to open the door.

IC Card

Touch keyboard to wake up the system, swipe the IC card on keyboard, then the door will be unlocked, pull down the handle to open the door.

Combined Unlock (Fp+Psw, Fp+IC, Psw+IC)

1. User need to verify both parts to unlock the door, there is no particular verification order.

Take “ Fp+Psw ” as example: user need to verify both fingerprint and password to unlock the door, user can verify fingerprint firstly or verify password firstly.

2. After the door is unlocked, both verification information will be saved in lock.

3. After the door is unlocked, user will only receive one part of verification information on App.

4. If anyone use rob fingerprint/password in the combined verification ways, after the door is unlocked, user will receive force alarm on App.

Note : the 3rd function and the 4th function will only realized when the lock is connected to gateway.

Battery Installation Issues

Unscrew the battery cover, take down the cover, then install the batteries. Install the cover and tighten the screws.

Attentions

Please use the correct battery type to avoid explosion.

Please remove the battery if the lock will not be used for a long time.

Please install the batteries’ positive/negative terminals correctly.

Lock installation guidance

Check Direction of Opening the Door

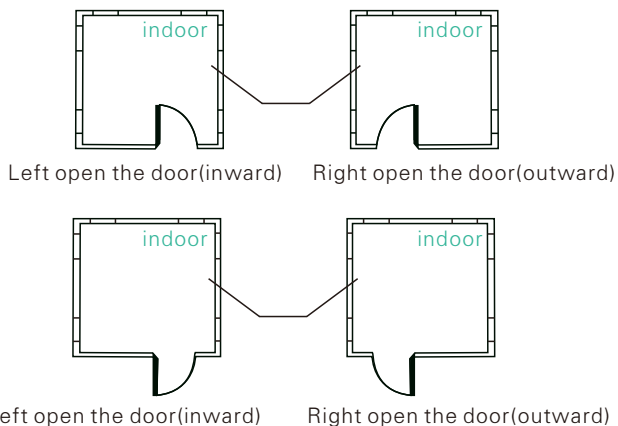

Left open the door

Stand outside the door, and face to the door. If the fixed hinge is on the left, the door is defined as left opening which includes left inward and left outward.

Right open the door

Stand outside the door, and face to the door, when the fixed hinge is on the right, the door is defined as right opening which includes right inward and right outward.

Material list



- | | | |
|-------------------|--|---------------------|
| ① Spring | ② Fixing piece and core of lock cylinder | ③ Screws |
| ④ Mechanical key | ⑤ Lock cylinder | ⑥ Small square iron |
| ⑦ Big square iron | ⑧ Retainer sleeve | |

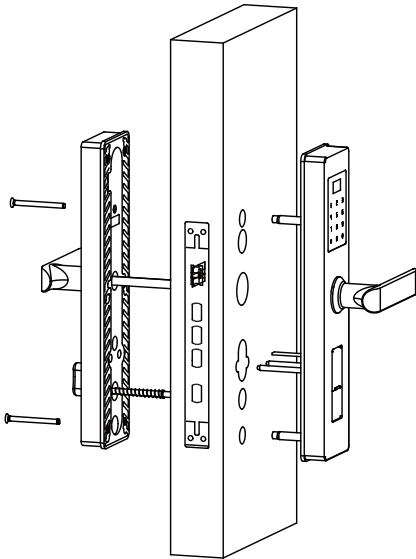

Overview

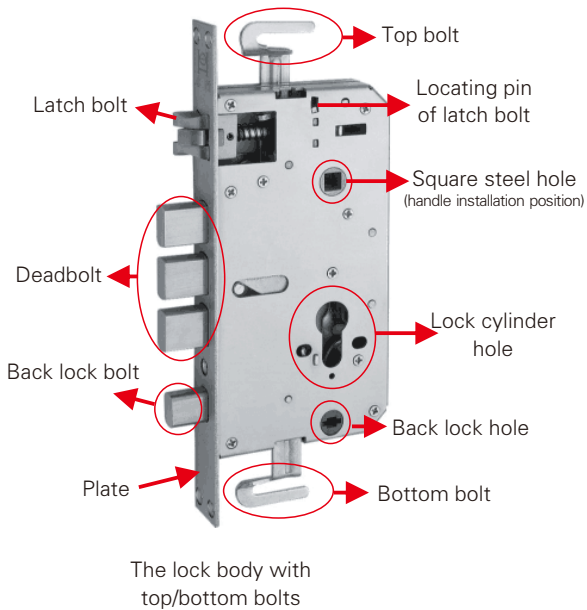

Pinch plate

Lock Body Installation

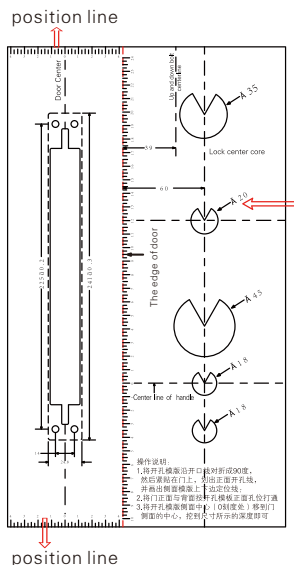

1. Fold the template paper along the lines; attached the paper on the door, draw the hole lines at the front, and then draw position line of the lateral template.

Note : it is better to make lock cylinder hole 1 meter high from the ground.

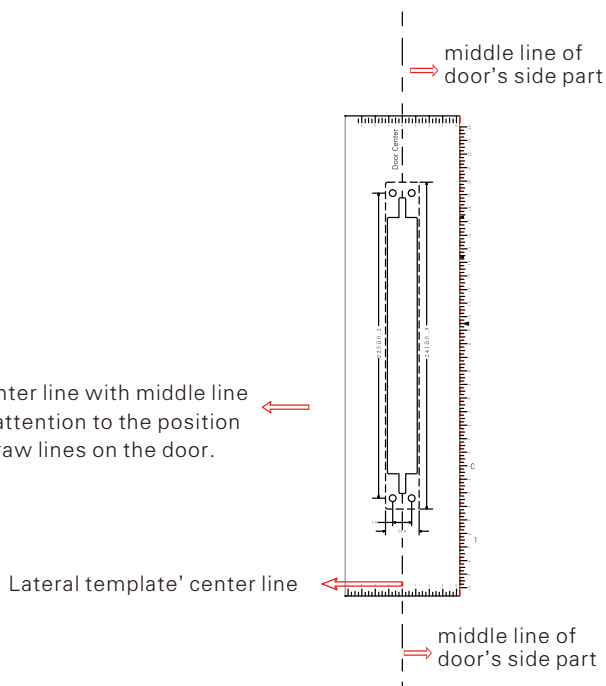

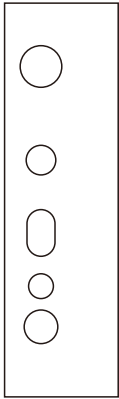

3. Punch holes on the door according to the drawn lines. Set the installation location of the lock shell and Lock body pinch plate according to the lock body position. (suitable for wooden door)

Note: if the door already punched holes, then user need to provide below information to seller.

- a. the distance between square steel hole and lock cylinder hole.
- b. the distance between lock cylinder hole and knob hole .
- c. the length and width of pinch plate.
- d. after lock the door, touch its top and bottom to check whether there is lock tongue pop out or not.

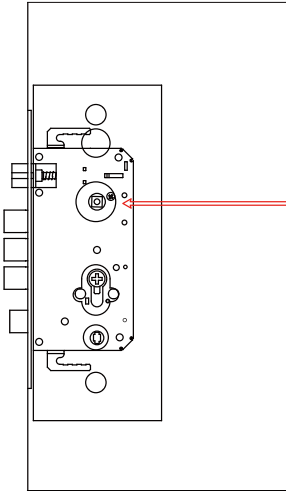

4. installed lock body in its hole and then fix it with screws.

Note: the latch bolt must be at the upper end, and the latch bolt direction must be opposite to the door closing direction. If the direction is inconsistent, please pull up the locating pin of latch bolt, press the latch bolt into the lock body, then user can manually adjust latch bolt direction.

5. Install the pinch plate.

Note: please align the pinch plate hole with the corresponding lock tongue before fix it with screws.

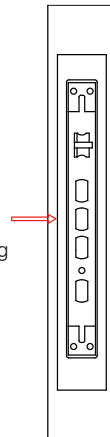

Faceplate Installation

① Check whether the handle have the same direction as opening door.

Note: if they are not in the same direction, user need to withdraw the handle screw and then adjust the handle direction, please remember to tighten handle' s screws finally.

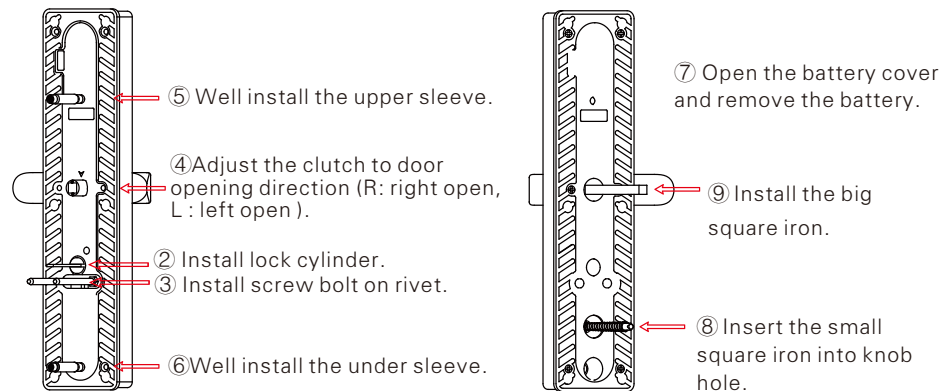

⑩ Well install front faceplate on the door

Note: put the guide line across the door hole, the square iron sheathed to the inside clutch, make column across the lock body.

⑪ Connect the rear faceplate guide line with the front faceplate guide line.

⑫ Mount rear faceplate on the door, and align the front faceplate with the rear faceplate.

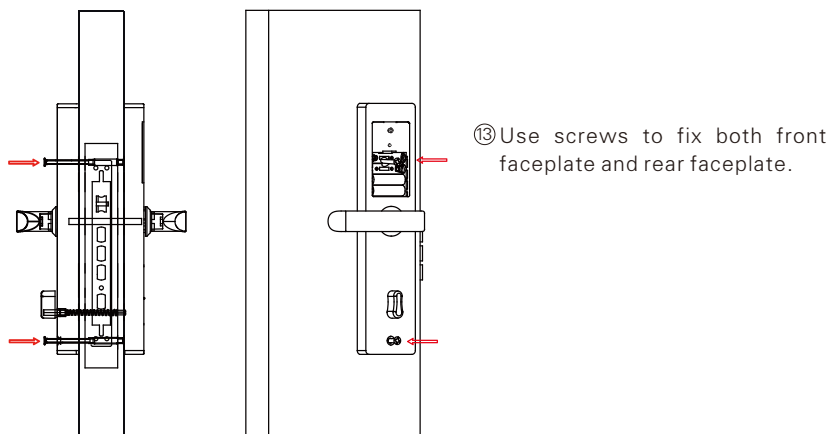

⑭ Install batteries for door lock, check to see if the lock can be switched/back locked normally.

Maintenance

- ⚠ Don't make the lock touch corrosive substances.
- ⚠ Don't hang objects on the handles.
- ⚠ If the door is deformed, the latch bolt may cause big friction when user lock the door, please adjust the door buckle plate position to solve the problem.
- ⚠ After the fingerprint collection window is used for a long time, the surface will be stained with dirt or moist, please wipe it gently with a dry and soft cloth.
- ⚠ When the batteries are under low voltage, please replace them immediately, please choose the right battery model and install batteries in correct way.
- ⚠ Please well keep the mechanical key and IC card.
- ⚠ Don't use hard or sharp objects to scratch the surface of the fingerprint collection window (include the fingernail),and don't make glue or ink applied to the fingerprint collection window.
- ⚠ If the lock is not flexible or can not maintain the correct position, please ask professional staff to add mechanical lubricants for the lock cylinder.
- ⚠ It is recommended to check lock rotating parts every six months, keep lock rotating parts with lubricant, and check whether the retaining screws are tight enough.
- ⚠ When the mechanical key can not open door smoothly, you can put a little graphite powder or pencil powder in the mechanical keyhole. Forbid to add any oil or lubricant, which may cause the lock can not be unlocked because the grease cling to marbles and spring.

